

## INSTALLATION INSTRUCTION BOLLARD LAMP (VT-909)

### TECHNICAL PARAMETERS

Model	VT-909
Watts	9W
Lumens	500LM
LED Chip Solution	6V 150mA
No. of LED	8pcs
Beam Angle	240°
CRI	>80
PF	>0.9
Output Voltage	25.6V
Body Type	Die Cast Aluminium
Class Type	CLASS I
Operation Temperature	-20°-+40°
Surge Protection	1500V
Dimension	200x80x300H mm
Input Power	AC: 100-240V 50/60Hz



**2** YEARS  
WARRANTY\*

**IP54**  
RATING

### INTRODUCTION & WARRANTY

Thank you for selecting and buying V-TAC product. V-TAC will serve you the best. Please read these instructions carefully before starting the installation and keep this manual handy for future reference. If you have any other query, please contact our dealer or local vendor from whom you have purchased the product. They are trained and ready to serve you at the best. The warranty is valid for 2 years from the date of purchase. The warranty does not apply to damage caused by incorrect installation or abnormal wear and tear. The company gives no warranty against damage to any surface due to incorrect removal and installation of the product. The products are suitable for 10-12 Hours Daily operation. Usage of product for 24 Hours a day would void the warranty. This product is warranted for manufacturing defects only.

### WARNING!

1. Please make sure to turn off the power before starting the installation.
2. Installation must be performed by a qualified electrician.
3. The light source of this luminaire is not replaceable, when the light source reaches its end of life the whole luminaire should be replaced.
4. Proper grounding should be ensured throughout the installation.
5. To comply with all safety standards, the product must be used only for the purpose described in this instruction and must be installed in accordance with the wiring rules and regulation in the location where it is installed.
6. Check whether the product has been damaged during transport. Do not operate/install any product which appears damaged in any way. Return the complete product to the place of purchase for inspection, repair or replacement.
7. Lock out and tag the input circuit before accessing the wiring connections.
8. Hazardous voltage may be present at the wire leads of this product.
9. During and after use, the product may be hot.  
Do not touch the product before it has completely cooled down.
10. Failure to follow these instructions can result in minor injuries, or equipment damage.
11. Take care not to pull any electrical wires during unpacking as this may damage the connections.
12. Isolate the electrical supply before commencing any work on this equipment.



**MULTI-LANGUAGE  
MANUAL QR CODE**

Please scan the QR code to access the manual in multiple languages.



This marking indicates that this product should not be disposed of with other household wastes.



This symbol indicates dangers to the life and health of persons due to hot surface.

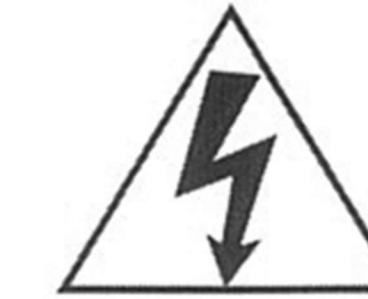

Caution, risk of electric shock.

### INSTALLATION DIAGRAM

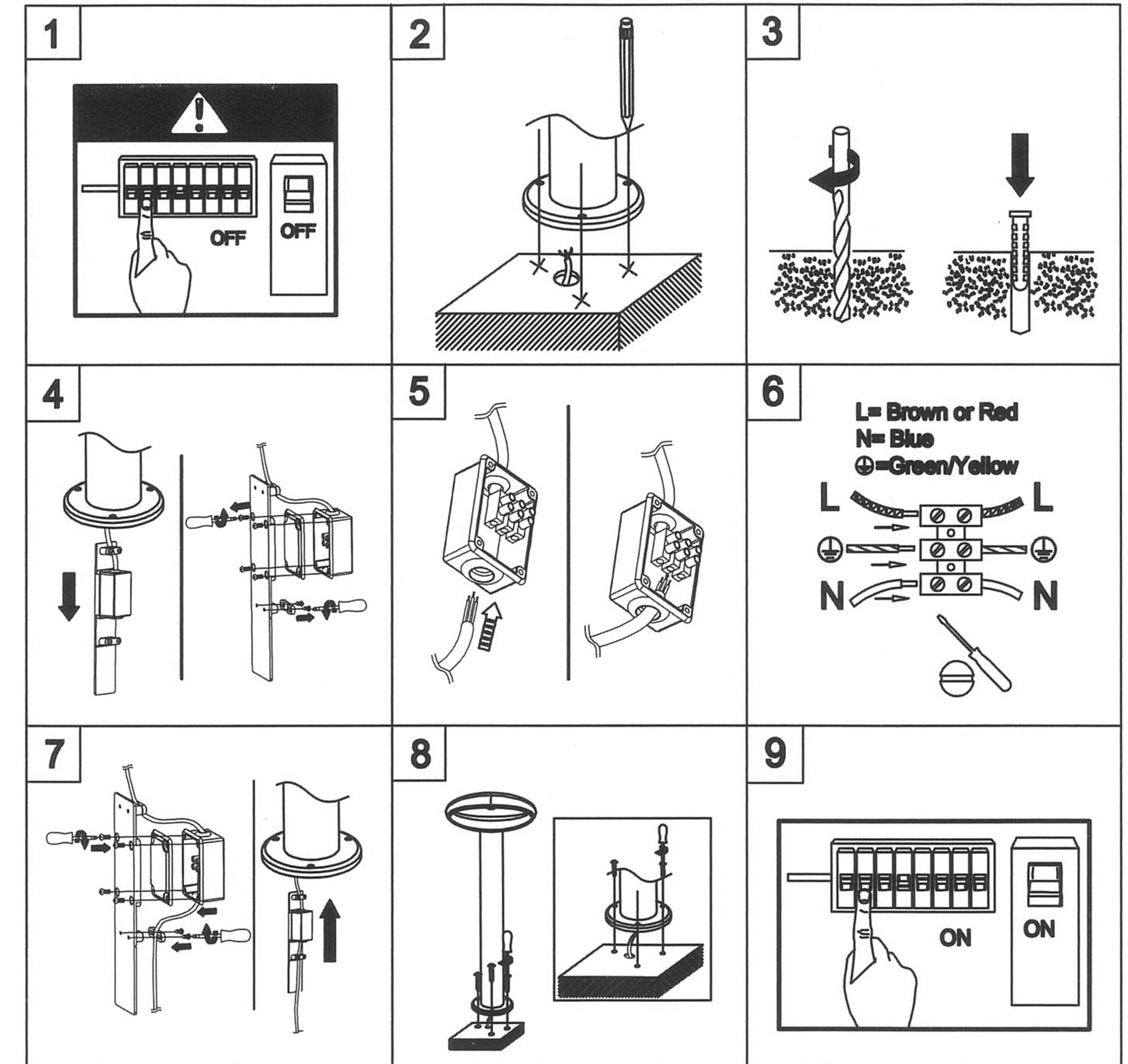

### INSTALLATION INSTRUCTIONS

- Remove all packaging material from the product.
- Turn off power to related lighting circuit.
- Mark hole centers from fixing mounting base and drill holes.
- Pick out terminal box from lamp body and open the box for wiring.
- Close the terminal box and put it in lamp body.
- Screw the mounting base.
- Turn on the power and test the light.