

INSTALLATION INSTRUCTION

MODEL: VT-875
SPOTLIGHT FITTING

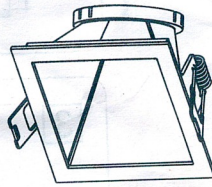
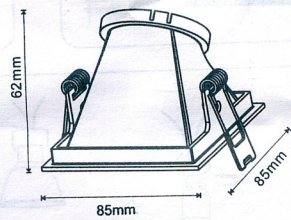
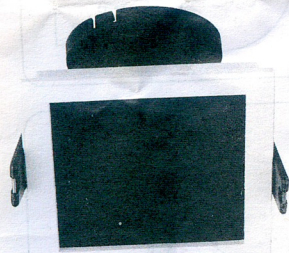

INTRODUCTION

Thank you for selecting and buying V-TAC LED SPOTLIGHT FITTING. V-TAC will serve you the best. Please read these instructions carefully before starting the installation and keep this manual handy for future reference. If you have any other query, please contact our dealer or local vendor from whom you have purchased the product. They are trained and ready to serve you at the best.

INSTALLATION INSTRUCTIONS

- 1, Switch off the power.
- 2, Ensure that the void depth is minimum 90mm and the thickness of the ceiling is maximum 20mm. (Pic 1).
- 3, Drill the appropriate hole on the ceiling as per the cut-out size. (Pic 2)
- 4, Put the LED bulb into the fixture. (Pic 3)
- 5, Connect the power 220-240V. (Picture 4)
- 6, Holding the spring clip upwards and put the fixture into the hole and ensure the fixture are installed properly. (Pic 5)
- 7, Switch on the power if above steps are done properly without any mistakes.

V-TAC[®]

INNOVATIVE LED LIGHTING

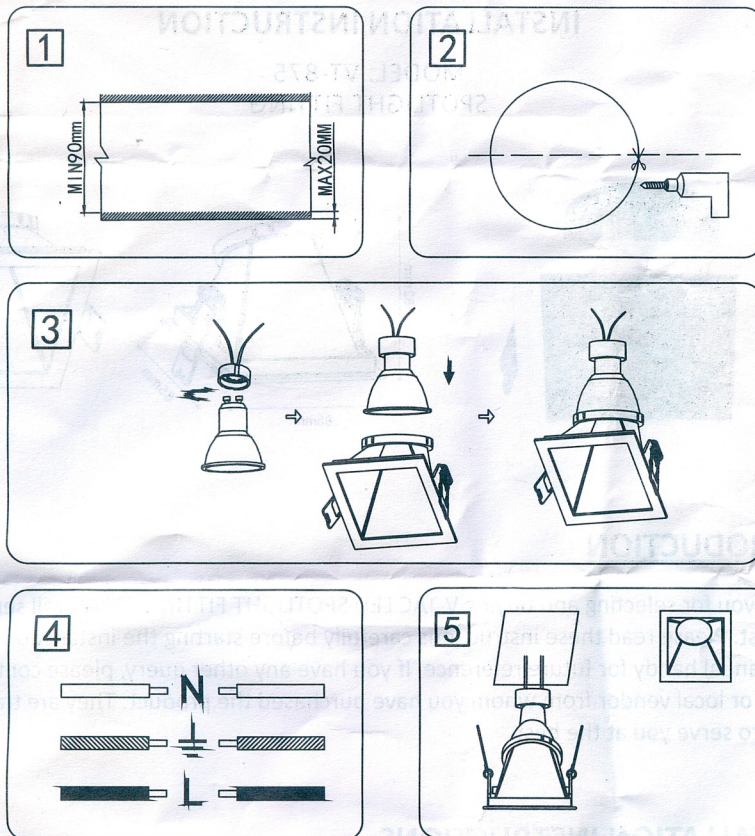

WARRANTY

- This product is warranted from manufacturing defect only.
- The warranty is valid for 2 years from the date of purchase.
- The warranty does not apply to damage caused by incorrect installation or abnormal wear and tear.
- The company gives no warranty against damage to any surface due to incorrect removal and installation of the product

In case of any query /issue with the product please reach out to us at support@vtacexports.com